

TRIBUNALE ORDINARIO DI CAMPOBASSO

Sezione fallimentare

Fallimento 

RG n.17/2021

Giudice dott.ssa Claudia CARISSIMI

Curatore Fallimentare dott. Enrico DI NUCCI

C.T.U. ing. Antonello Santino PANICHELLA

Fabbricato in Civitacampomarano (CB) di cui al FG.21, P.IIa 218

ALLEGATO 3

RILIEVO METRICO

RILIEVO CIVITACAMPOMARANO - FG.21 P.LLA 218

PIANO PRIMO - RILIEVO

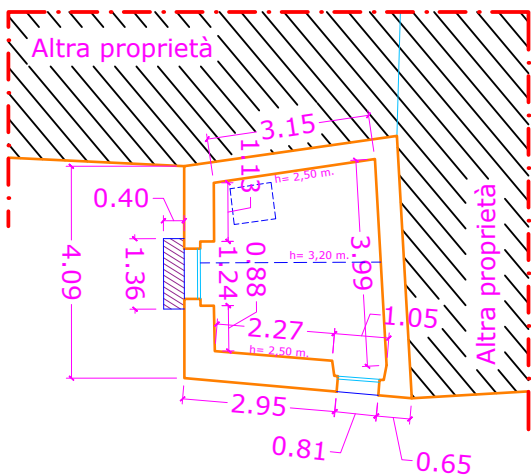

PIANO PRIMO - SUPERFICI

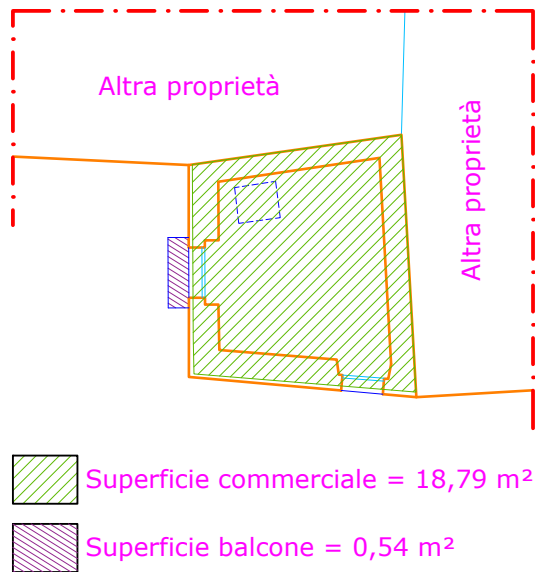

PIANO TERRA - RILIEVO

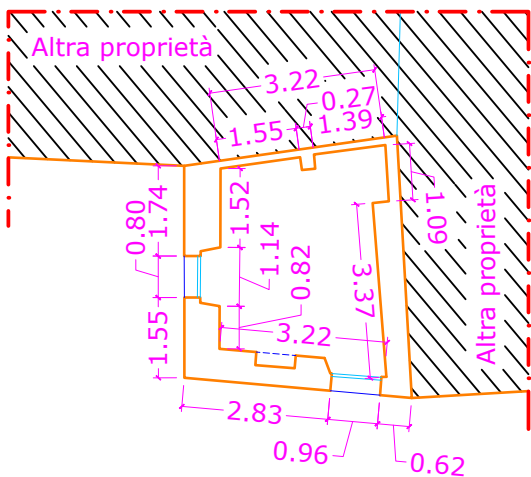

PIANO TERRA - SUPERFICI

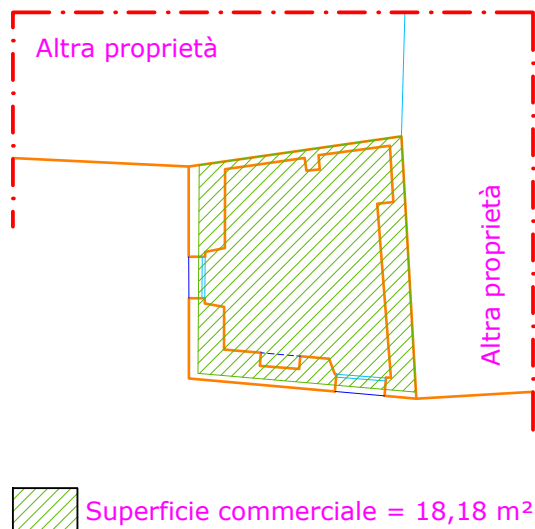

PIANO SOTTOSTRADA - RILIEVO

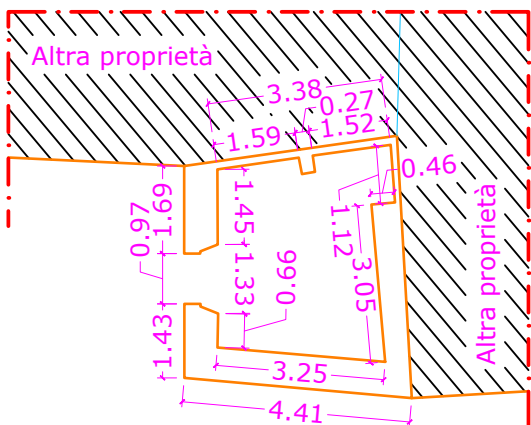

PIANO SOTTOSTRADA - SUPERFICI

